

**FEATURES:**

- Material: Bright Galv.
- Gasketing package provided.
- Insulation: 1"-1.5 lb. Density.
- Estimated Weight: 72 Lbs.
- All Welded Construction.

**CURB ADAPTER**

EXISTING RHEEM:  
RPND, RPNC 030-036

FOR YORK UNITS:  
PCG4B, PCE4B 048-060 / PHE4B, PHG4B 036-060

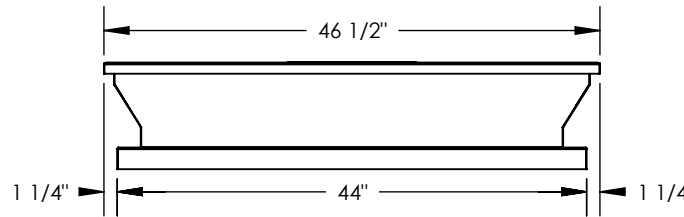

**FRONT VIEW**

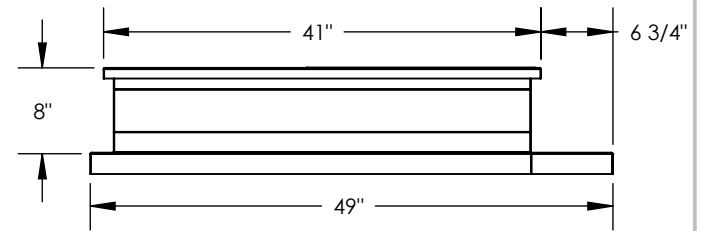

**FRONT VIEW**

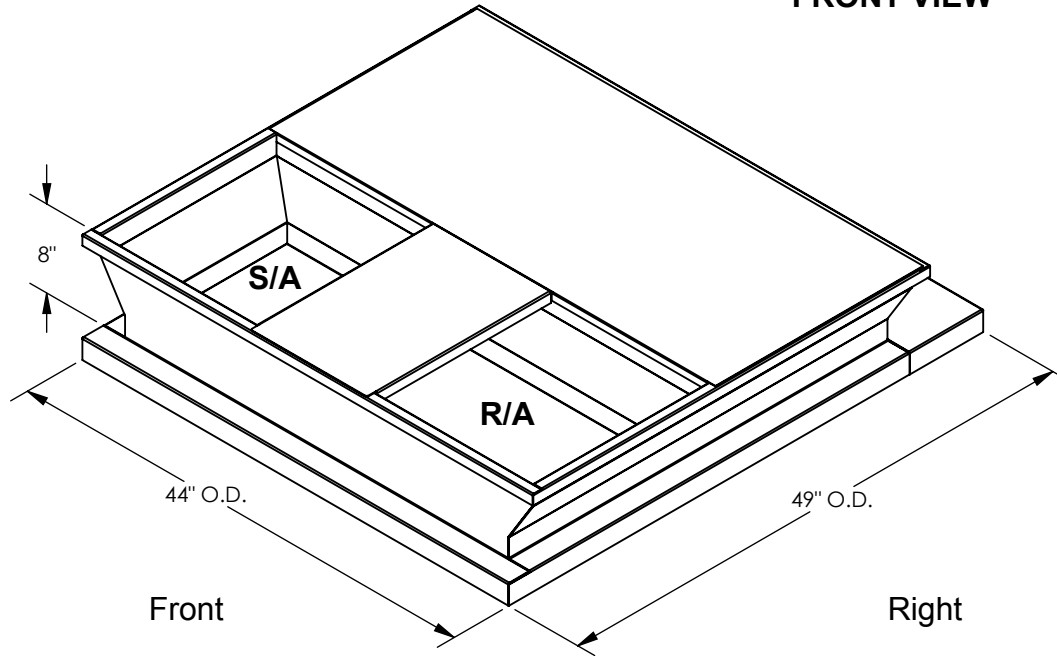

**ISOMETRIC VIEW**

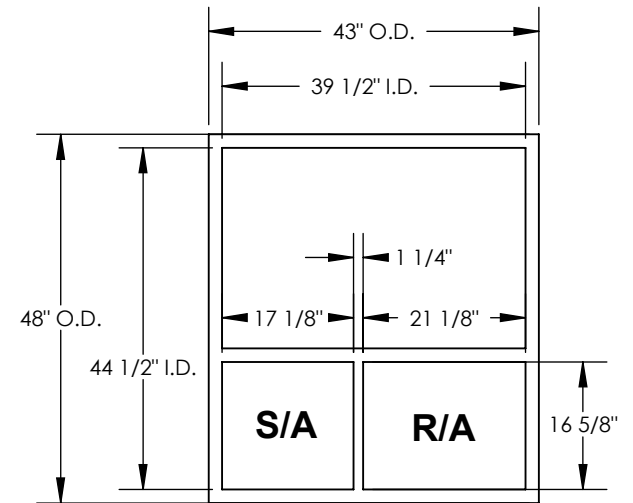

**EXISTING CURB**



3847 WABASH DRIVE  
MIRA LOMA, CA 91752

PHONE (951) 685-1101  
FAX (619) 872-9799

SUBMITTED TO: \_\_\_\_\_  
COMPANY: \_\_\_\_\_  
JOB NAME: \_\_\_\_\_  
EQUIPMENT: \_\_\_\_\_  
NOTES: \_\_\_\_\_

FORM NO: \_\_\_\_\_  
DATE: 10/10/2016

PART NUMBER:  
CA-LXL-RHM01  
REV: -  
DRAWN BY:  
ALL