

For wood, concrete and steel attachments see Roof Anchorage Detail, Form No. CB-60.

Will conform to seismic code requirements for knock-down or pre-assembled application. (Contact factory for assembled version.)

STRUCTURALLY CALCULATED HOLD DOWN CLIPS FOR KNOCK-DOWN ROOF CURBS FOR YORK UNITS

P*A ALL MODELS**

ProVent P/N	A	WEIGHT
CBKDLXS08	8"	43 Lbs
CBKDLXS11	11"	54 Lbs
CBKDLXS14	14"	65 Lbs

SEISMIC KIT P/N	WEIGHT
KDKITLX	5 Lbs

Meets seismic requirements for the following codes:
CBC 2019
IBC 2018

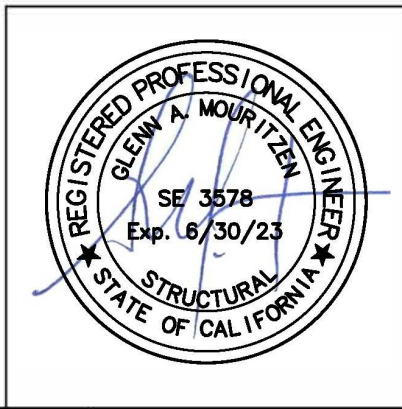
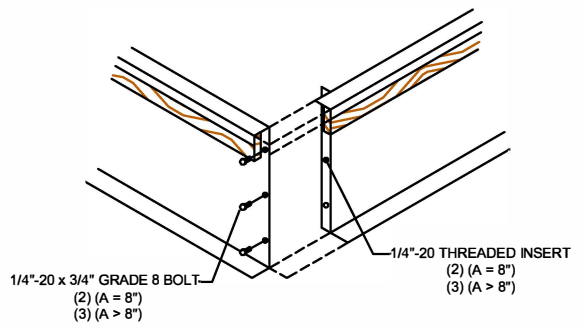
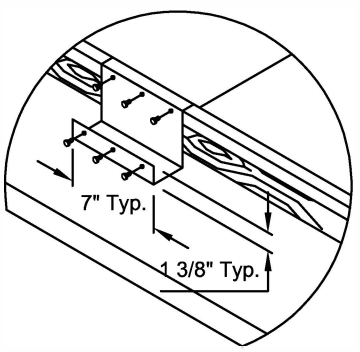
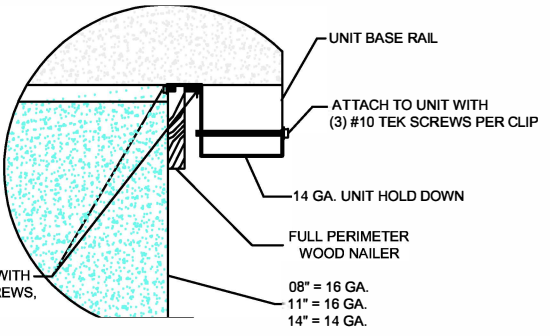
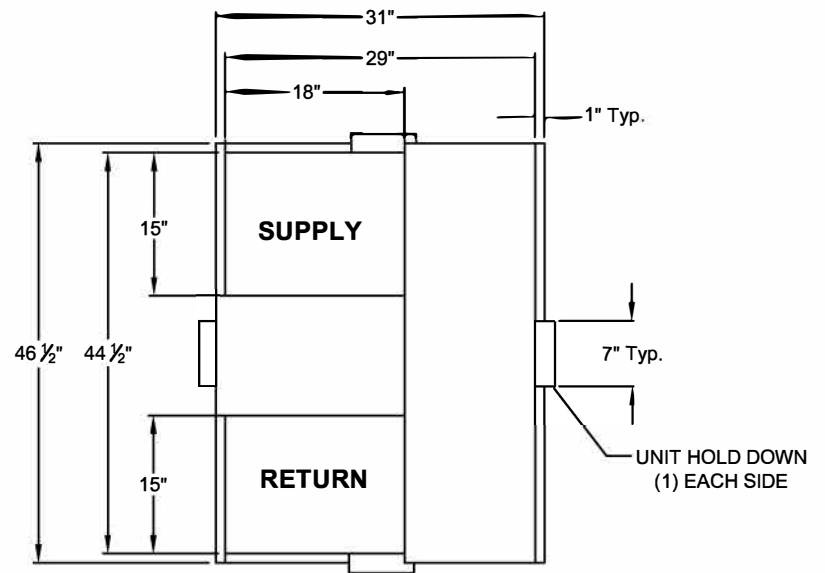
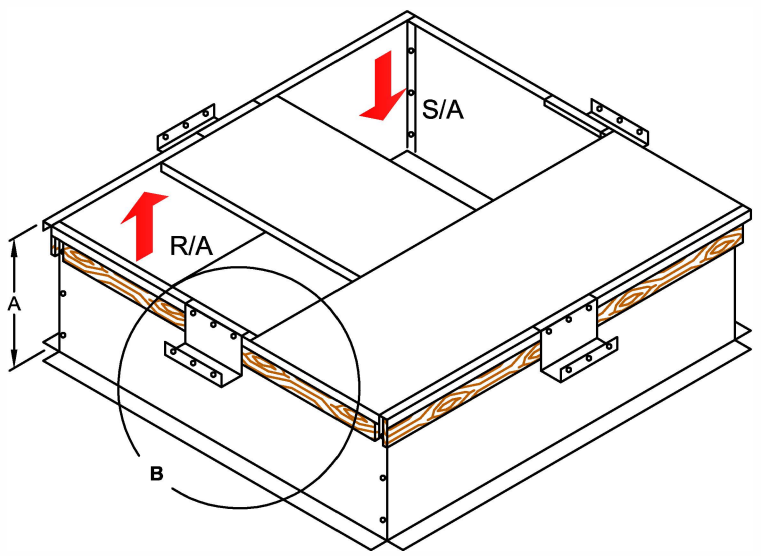

3847 WABASH DRIVE
MIRA LOMA, CA 91725

PHONE (951) 685-1101
FAX (619) 872-9799

SUBMITTED TO: _____
COMPANY: _____
JOB NAME: _____
EQUIPMENT: _____
NOTES: _____

FORM NO:
CBKD-152

DATE:
3/26/2021

REV:
7

PART NUMBER:
KDKITLX

DRAWN BY:
ALL