

FEATURES

- 18 ga. galvanized steel construction.
- Fully welded construction.
- Large 2" built-in 45° cant is beveled at corners.
- Lined with 1"-1½ lb. fiberglass, insulation.
- Wood nailer provided.
- Damper shelf provided.
- Gasketing provided.

NOTES

- Inside of curb is 3" less than dimension "A".
- Curb dimension "A" is 1½" less than fan base allowing ¾" each side for flashing material and clearance.
- When using a motor operated damper in the curb, a 12" high (minimum) curb is required.

FAN CURBS

FAN SIZE	A SQ.	ProVent P/N		
		B = 8"	B = 12"	B = 18"
070 - 085	15.50 x 15.50	RC15508	RC15512	RC15518
100 - 120	18.50 x 18.50	RC18508	RC18512	RC18518
140	22.50 x 22.50	RC22508	RC22512	RC22518
160	24.50 x 24.50	RC24508	RC24512	RC24518
180 - 210	28.50 x 28.50	RC28508	RC28512	RC28518
240	32.50 X 32.50	RC32508	RC32512	RC32518
300	38.50 x 38.50	RC38508	RC38512	RC38518
360	44.50 x 44.50	RC44508	RC44512	RC44518
420	50.50 x 50.50	RC50508	RC50512	RC50518
480	56.50 x 56.50	RC56508	RC56512	RC56518

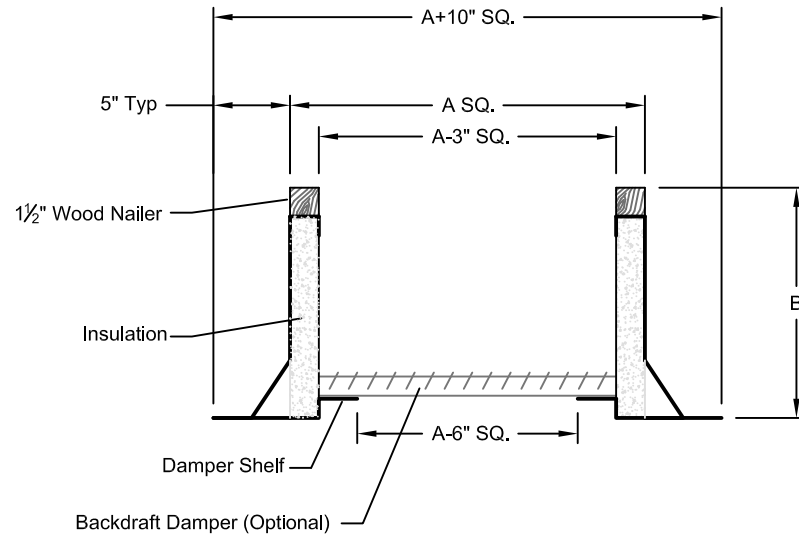
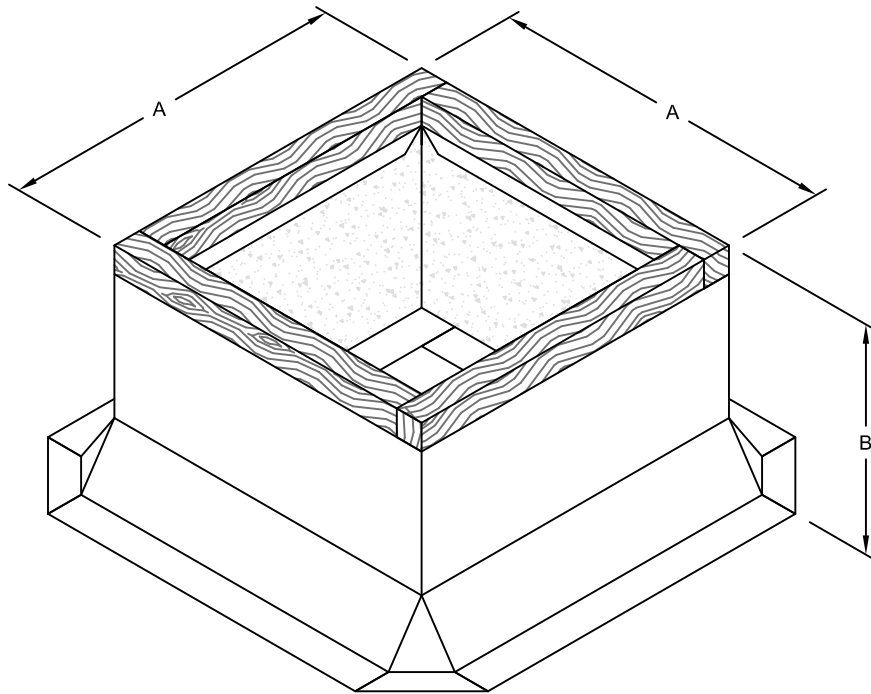

1392 E. PALOMAR ST., # 403-234
CHULA VISTA, CA 91913

PHONE (619)
FAX

SUBMITTED TO: _____
COMPANY: _____
JOB NAME: _____
EQUIPMENT: _____
NOTES: _____

FORM NO:
RC-101

DATE:
07/08/08

PART NUMBER:
RC SERIES

DRAWN BY:
FMM